

## **2ND OPTION FEEDER (Machine code: G342)**

# 1. REPLACEMENT AND ADJUSTMENT

## 1.1 EXTERIOR COVERS

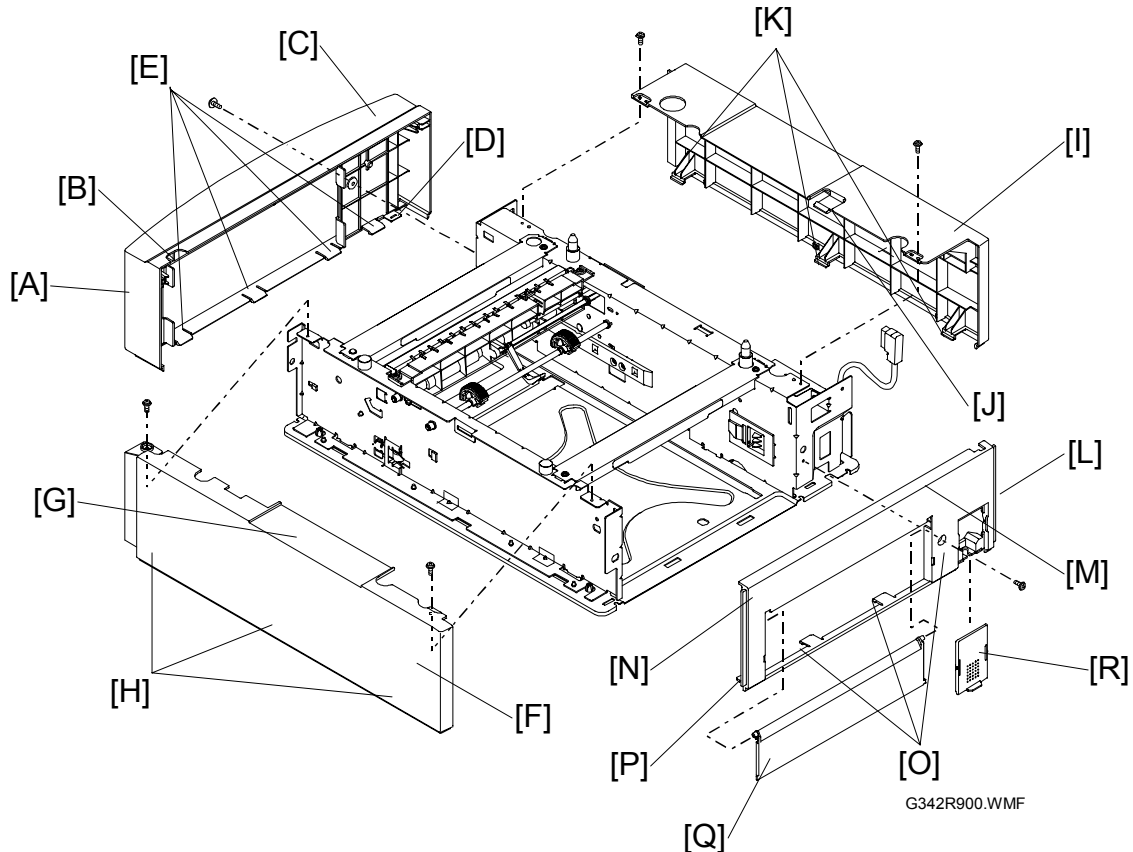

1. Front cover [A] (🔧 x 1)  
**NOTE:** Release both hooks [B] [C] on the top and five hooks [D][E] on the bottom.
2. Right cover [F] (🔧 x 2)  
**NOTE:** Release one hook [G] on the top and three hooks [H] on the bottom.
3. Left cover [I] (🔧 x 2)  
**NOTE:** Release one hook on the top [J] and three hooks [K] on the bottom.
4. Rear cover [L] (🔧 x 1)  
**NOTE:** Release two hooks [M][N] on the top and five hooks [O][P] on the bottom.
5. Cassette cover [Q]
6. Connector cover [R]

## 1.2 FEEDER BOARD

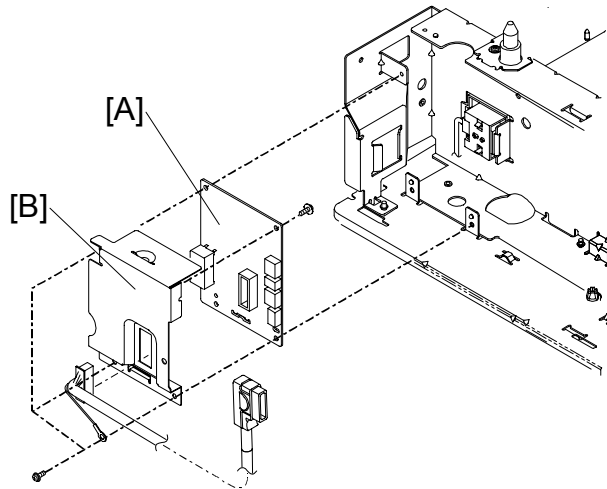

G342R901.WMF

- Left cover (☛ 1.1)

1. Feeder board [A] with shield cover. (☛ x 5, ⚙ x 3)
2. Shield cover [B] (⚙ x 1)

## 1.3 PAPER SIZE SWITCH

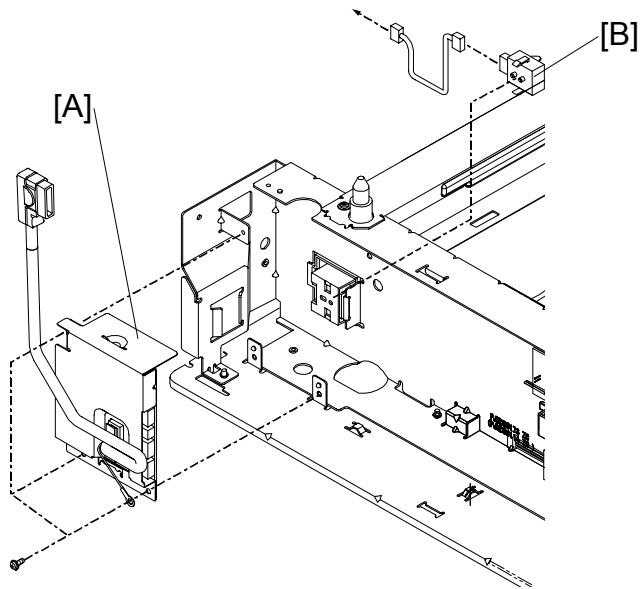

G342R902.WMF

- Left cover (☛ 1.1)

1. Feeder board unit [A] (⚙ x 3)
2. Paper size switch [B] (☛ x 1)

**NOTE:** The connector is located at CN5 on the feeder board.

## 1.4 SENSOR BOARD, MOTOR, AND PICKUP SOLENOID

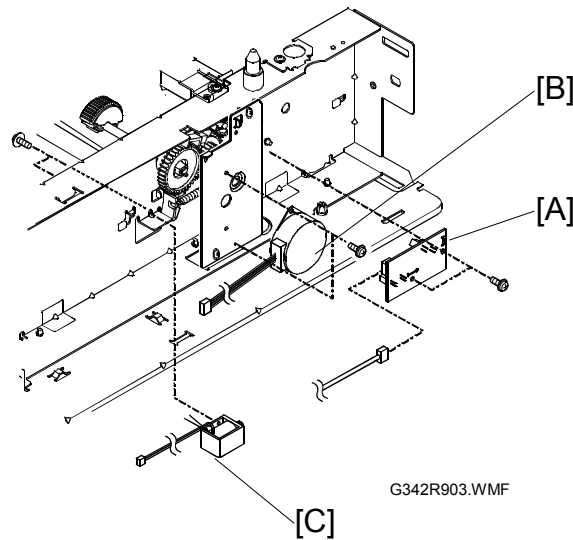

- Left cover (☛ 1.1)
- 1. Sensor board [A] (☛ x 2)
- 2. Motor [B] (☛ x 1, ☛ x 2)
- 3. Pickup Solenoid [C] (☛ x 1, ☛ x 2)

## 1.5 JAM SENSOR AND PAPER EMPTY SENSOR ARMS

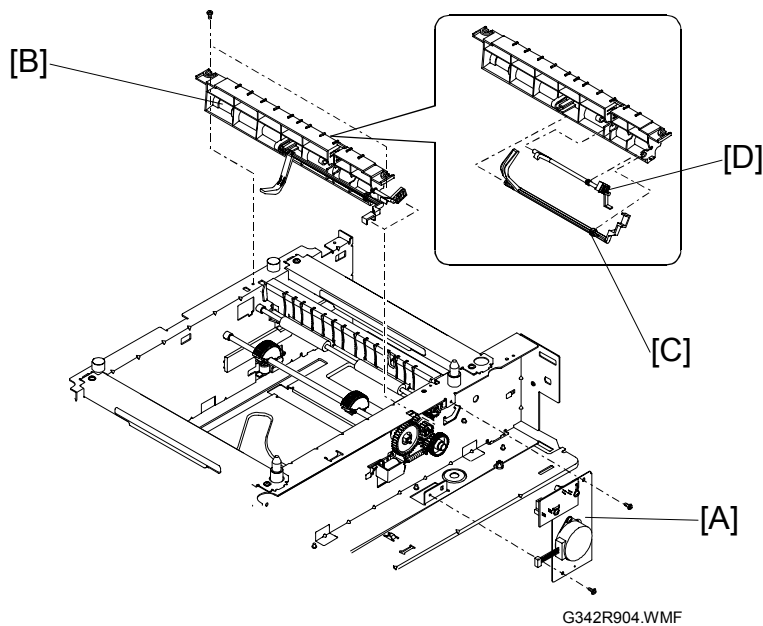

- Left cover (☛ 1.1)
- 1. Motor bracket unit [A] (☛ x 2)
- 2. Paper guide unit [B] (☛ x 2)
- 3. Paper empty sensor arm [C]
- 4. Jam sensor arm [D]

## 1.6 PICKUP AND PAPER FEED ROLLERS

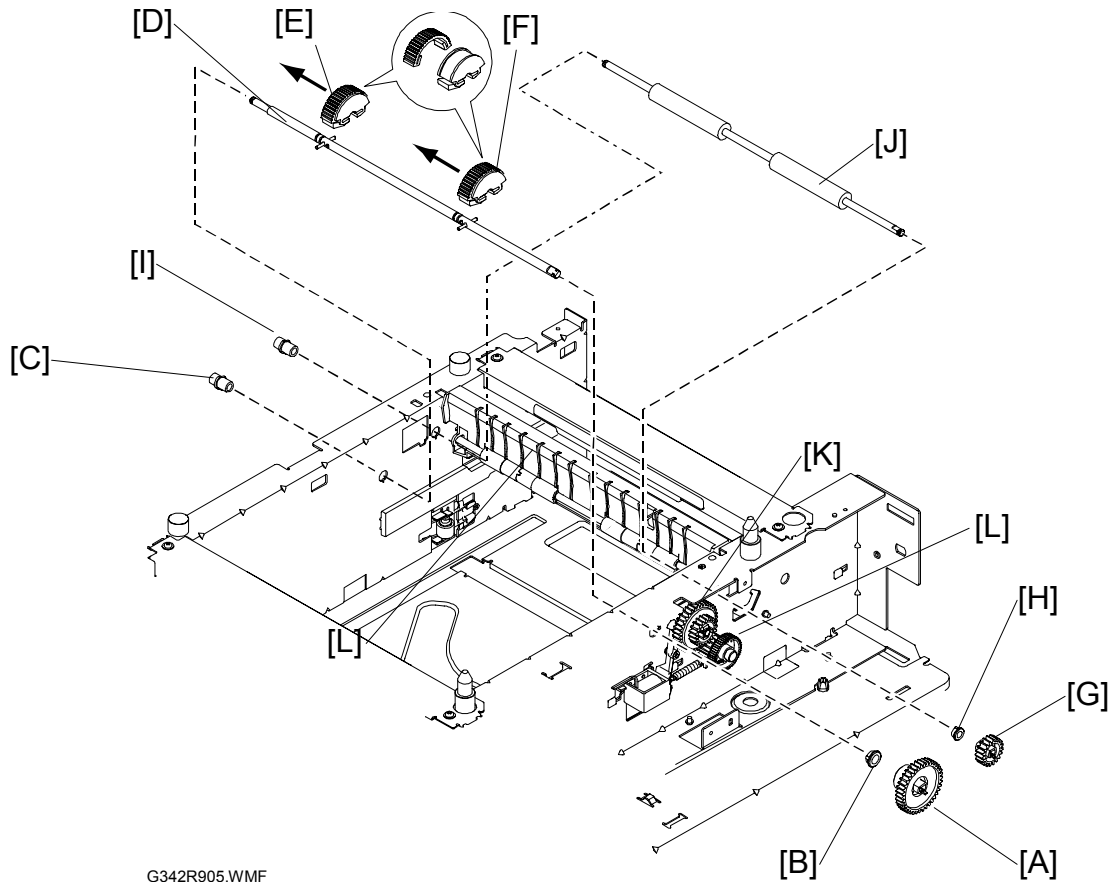

G342R905.WMF

- Left cover (☛ 1.1)

1. Pickup gear [A] (1 hook)
2. Bushing [B]
3. Bushing [C] (1 hook)
4. Pickup roller shaft [D]
5. 2 pickup roller assemblies [E][F] (1 hook each)
6. Feed gear [G] (1 hook)
7. Bushing [H]
8. Bushing [I] (1 hook)
9. Paper feed roller [J]

### *Lubricating*

Lubricate the following parts (Grease G501) when replacing them (parentheses indicate the amount of lubricant):

- The shafts on the outer gear [K] (0.05 cc x 2)
- The outer cogs on the 2 inner gears (in the outer gear [K]) (0.1 cc x 2)
- The outer cogs on the idle gear [L] (0.1 cc)
- The shafts of the outer gear [M] and the idle gear [L] (0.05 cc x 2)

## 1.7 PINCH ROLLERS

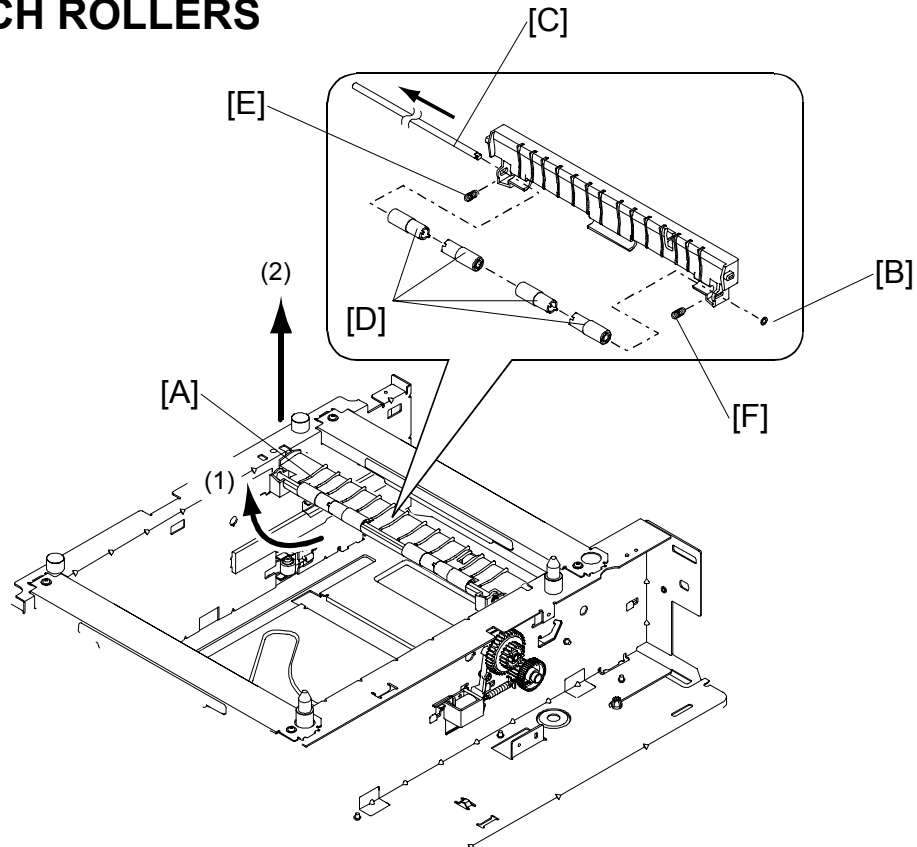

G342R906.WMF

- Left cover (➡ 1.1)
  1. Raise the pinch roller base unit [A] in the arrow (1) direction.
  2. Remove the pinch roller base unit in the arrow (2) direction.
  3. Plastic ring [B]
  4. Slide out the pinch roller shaft [C] in the arrow direction.
  5. 4 pinch rollers [D]
  6. 2 springs [E][F]

## 1.8 PAPER CASSETTE

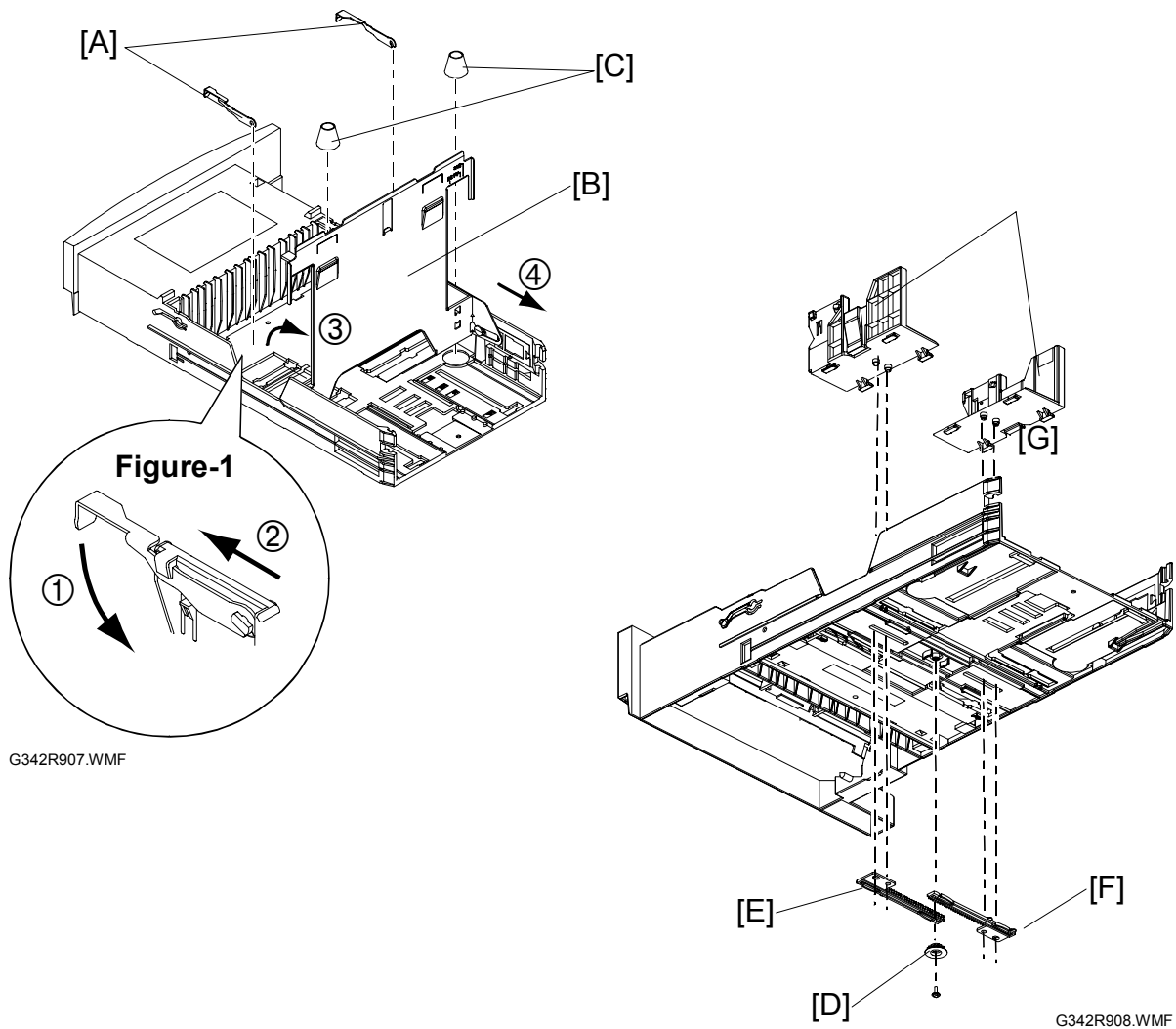

1. Corner separator [A]  
**NOTE:** Remove the corner separator by moving it as shown Figure-1.
2. Raise the cassette base plate [B] in the arrow ③ direction.
3. Slide the cassette base plate in the arrow ④ direction, and remove it.
4. 2 springs [C]
5. Pinion gear [D] and 2 racks [E][F] (⌀ x 2)
6. Left and right paper guides [G]

---

## 2. DETAILED DESCRIPTIONS

See the following subsections in the service manual of the main unit:

- 6.3.9—Paper Feed
- 6.5.3—Paper Source Selection
- 6.5.4—Auto Continue